

LogiSon Revit Families

Quick Facts:

Work with your LogiSon representative to decide on the proper components and placement for your system.

Keep in touch with your LogiSon representative for content updates.

All Revit Families are 'Face Based'.

All Revit Families have electrical and data.
connection points.

LogiSon Revit Families

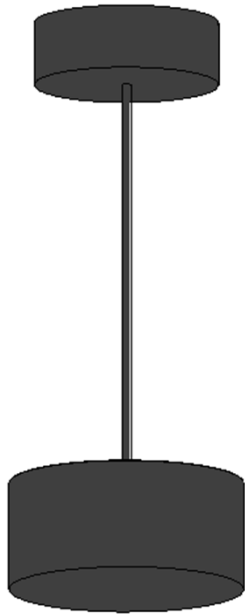

Sound Masking Unit: Suspended

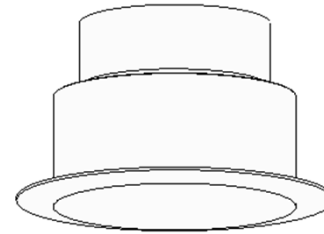

Sound Masking Unit: Ceiling

LogiSon Revit Families



Keypad



Power Supply

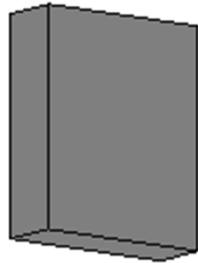

Network Control Panel

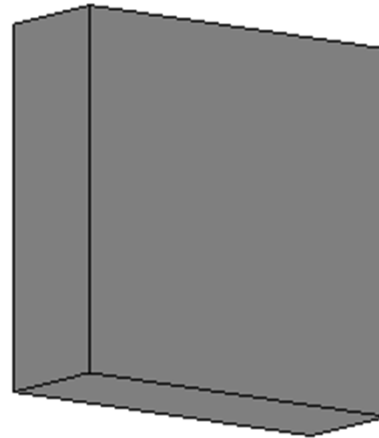

Failsafe Power Supply

LogiSon Revit Families



LogiSon_Network_Data_Device_Tag.rfa



Electrical Equipment Tag.rfa

LogiSon Revit Families

Sound Masking Unit, Ceiling Mount

Materials: LogiSon_Charcoal
 LogiSon_White

Types: PNH-1
 PNH-1p
 PNH-1A
 SNH-1

Instance Parameter 'Mark' is address, ie.99, 100

Revit File Name:
LogiSon_Sound_Masking_Unit_Ceiling.rfa

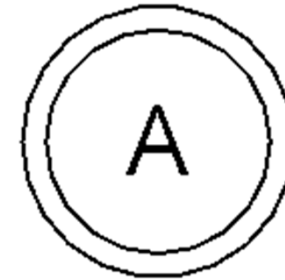

Typical Plan Symbol

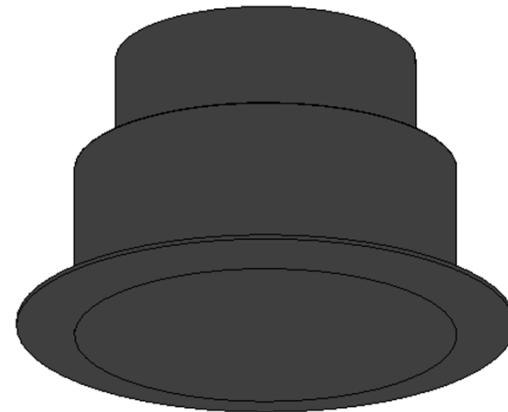

3D Isometric Shaded

LogiSon Revit Families

Sound Masking Unit, Suspended

Materials: LogiSon_Charcoal
 LogiSon_White

Types: PNH-1
 PNH-1p
 PNH-1A
 SNH-1

Instance Parameter 'Mark' is address, ie.99, 100

Revit File Name:
LogiSon_Sound_Masking_Unit_Suspended.rfa

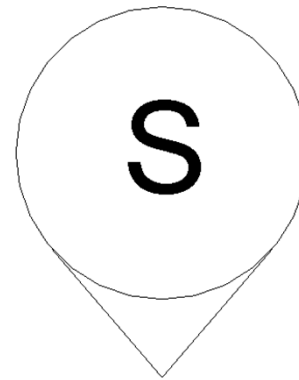

Typical Plan Symbol

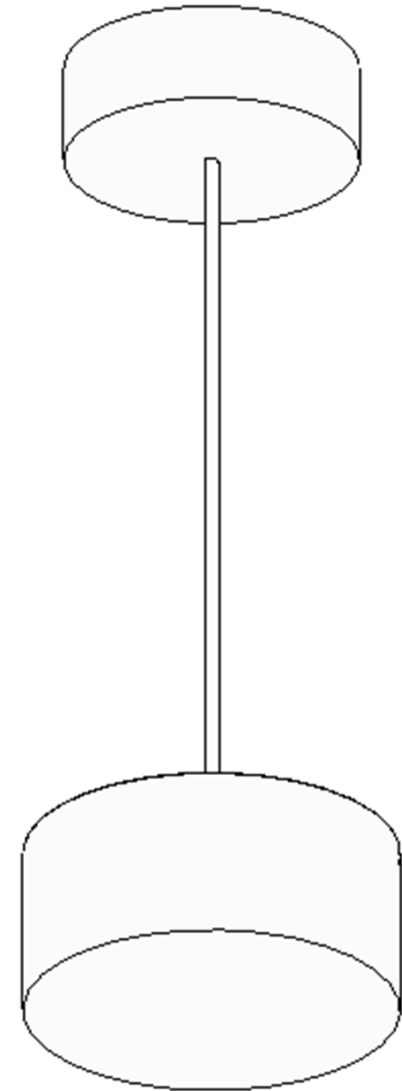

3D Isometric Shaded

LogiSon Revit Families

Keypad

Revit File Name:

LogiSon_Keypad.rfa

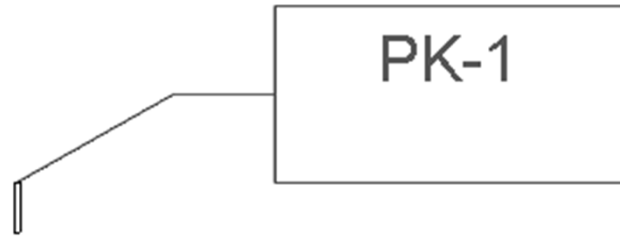

2D Plan View



3D Isometric View

LogiSon Revit Families

Network Control Panel

Revit File Name:

LogiSon_Network_Control_Panel.rfa

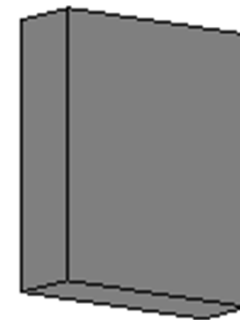
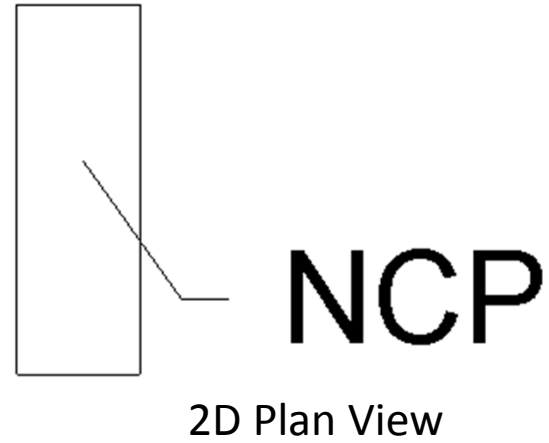

3D Isometric View

LogiSon Revit Families

Power Supply

Revit File Name:

LogiSon_Power_Supply_PS3.rfa

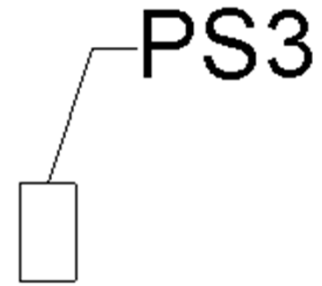

2D Plan View



3D Isometric View

LogiSon Revit Families

Failsafe Power Supply FPS

Revit File Name:

LogiSon_Failsafe_Power.rfa

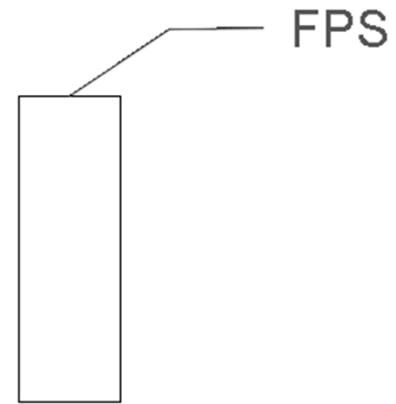

Plan View

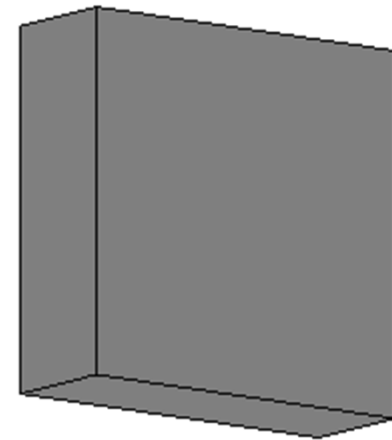

3D Isometric Shaded